

Stainless Steel Cake Stand Assembly Instructions

Parts List

- 1 - Bolt
- 2 - Plate
- 3 - Upper Stand
- 4 - Lower Stand
- 5 - Winged Nut

Instructions

Insert the Bolt (1) in to the hole in the centre of the Plate (2)

Place the Upper Stand (3) underneath the Plate so that the end of the Bolt protrudes through the hole in the bottom of the Upper Stand

Place the Lower Stand (4) underneath the Upper stand so that the end of the Bolt protrudes through the hole in the top of the Lower Stand

Screw the Winged Nut (5) on to the end of the bolt

Parts Diagram

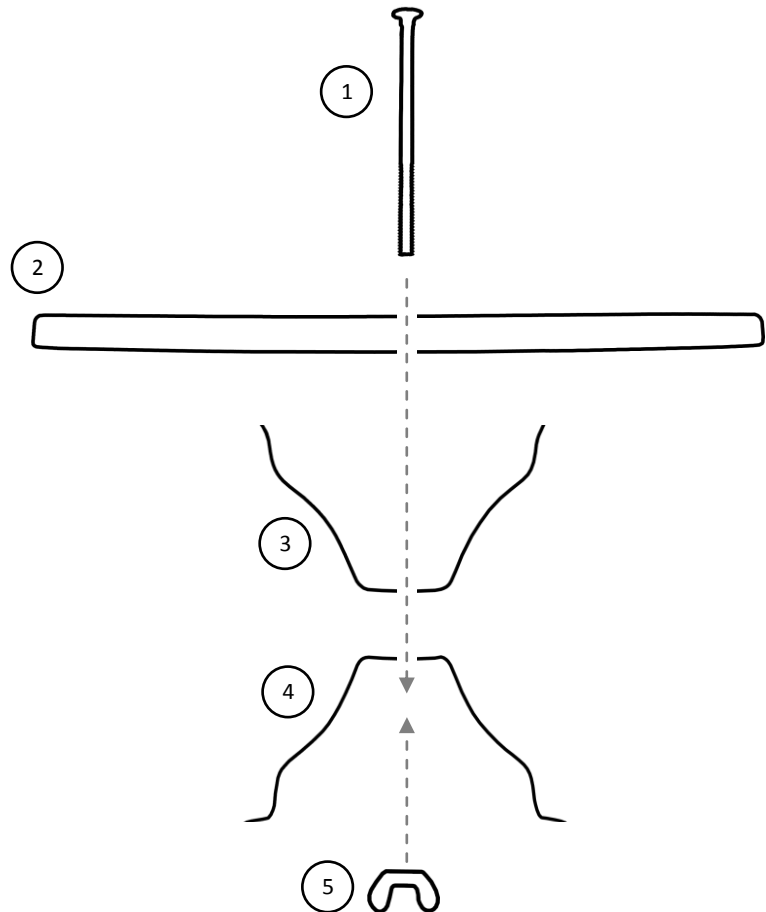

Assembled Cake Stand

